

STATE OF UTAH
 COUNTY OF KANE
 FILED FOR RECORD
 Price City
 OCT 17 1 32 PM '69
 BOOK 3 Plate
 PAGE 116
 AMY GREEN
 COUNTY RECORDER

S.W.COR. SE 1/4 NW 1/4 SEC 21 T 14 S R 10E S.L.M.

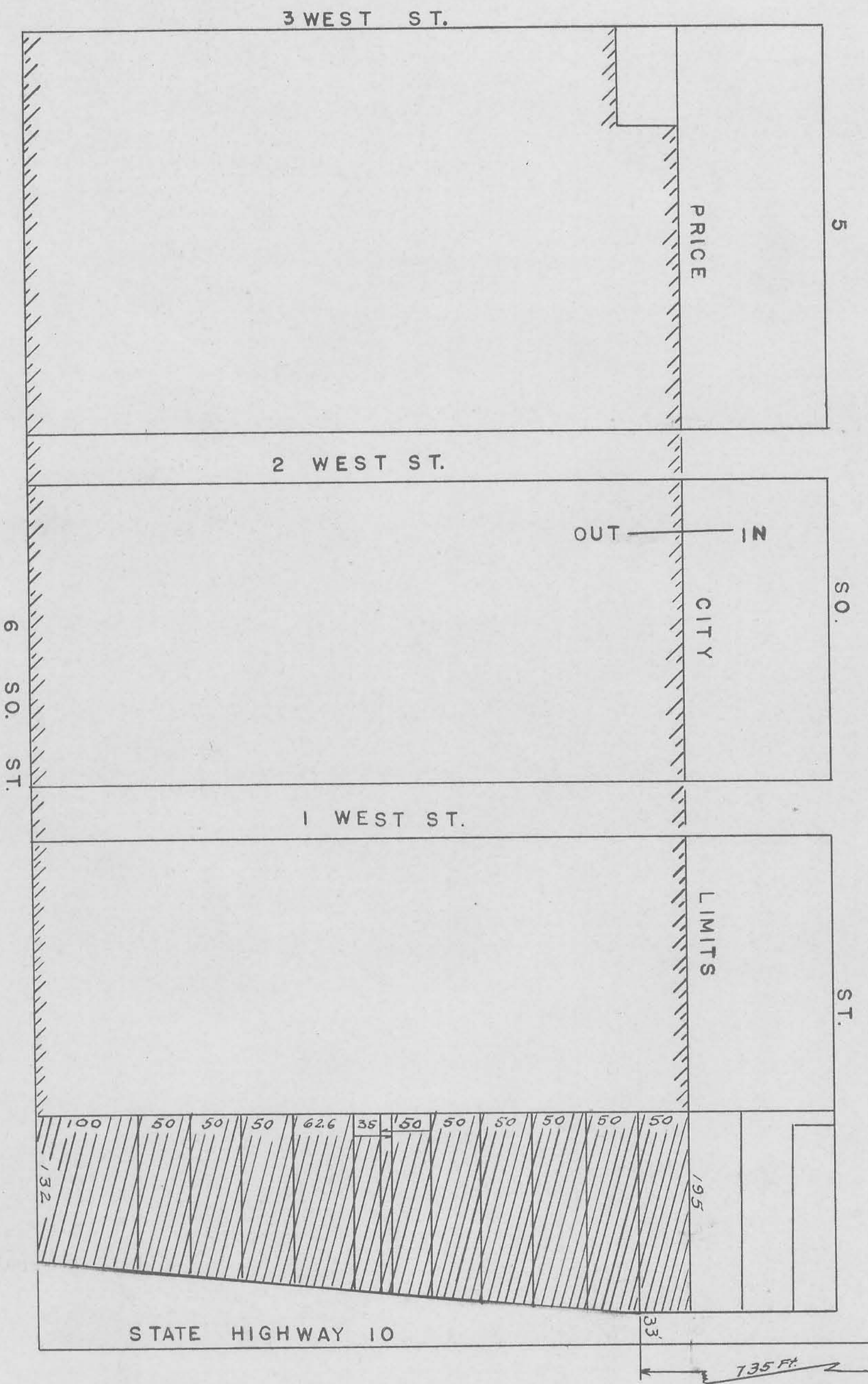

Entry No. 119124
 Indexed
 Abstracted
 Rec. Fee

PLAT SHOWING LAND ANNEXED TO PRICE CITY BY ORDINANCE NO. - 1224-69
 SCALE 1 IN. = 100 FT.

Approved and accepted and ordered annexed to Price
 Municipal Corporation by Ordinance #1224-69 dated
OCT. 13, 1969 adopted in regular session
 of the Council.

Murray Patton
 MAYOR
 KENNETH T. KASSER, CITY RECORDER

ENGINEERS CERTIFICATE

I, Dwight W. Mathias, by authority of the Mayor and Council of Price
 City, do hereby certify that this map is a true plat of the land to be
 annexed to the City of Price, Utah, by action of the City Council and
 Mayor by Ordinance #1224-69.

Said land is further described as follows:
 Beginning at a point which is 775 ft. South and 33 ft. West of
 the Southwest corner of the S&L of the NW 1/4 of Section 21, Town-
 ship 14 South, Range 10 East, S. 1. M., Thence North 50 ft. and
 running thence West along the present city limits of Price,
 Utah 195 ft; thence South 637.59 ft. more or less, to present
 corporate limits of Price City, Utah, thence East 132 ft.
 more or less to the West boundary line of Utah State Highway
 #10 and which is also designated locally as South Carbon Avenue;
 thence North easterly 390 ft. more or less along said Highway
 boundary to the point of beginning.

Dwight W. Mathias
 DWIGHT W. MATHIAS
 Acting City Engineer

Luke Fappas, Military Public
 Residing at Price, Utah
 My Commission expires EMUL 1970